

INSTALLATION INSTRUCTIONS

Accessory
CB RADIO ATTACHMENT KIT
 (P/N 08E96-MZ0-100)

Application
GL1500C

Publications No.

Issue Date
 September, 1997

Accessory Weight : kg (lbs)

READ THESE INSTRUCTIONS CAREFULLY.

1 PARTS LIST

Fig. 1

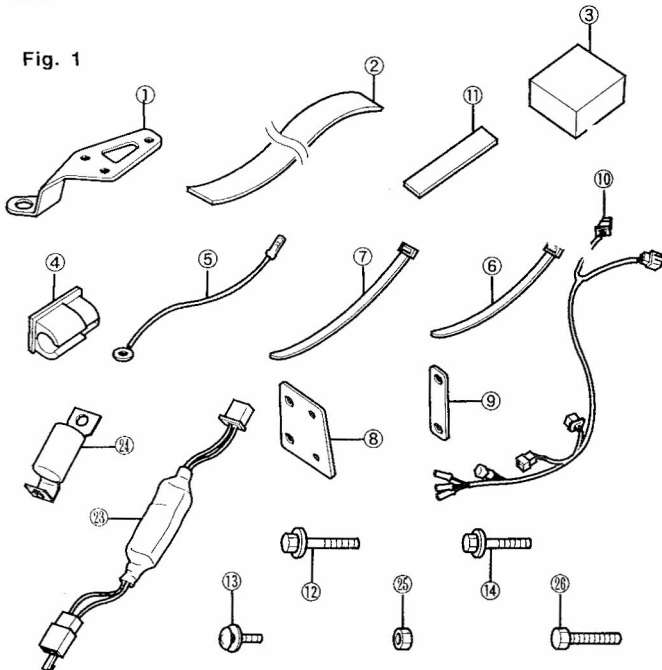

No.	Description	Q'ty	Part No.
①	Controller bracket	1	08E96-ME0-100-01
②	Fastener tape	2	08E96-ME0-100-02
③	Cushion A	2	17504-KG8-000
④	Holder	2	37242-MN5-000
⑤	Harness (negative power source)	1	08E96-MZ0-100-07
⑥	Band (Short)	10	90650-MA6-720
⑦	Band (Long)	5	90679-SG9-E01
⑧	Antenna bracket	1	08E96-MZ0-100-03
⑨	Rubber	1	08E96-MZ0-100-04
⑩	Main harness	1	08E96-MZ0-100-06
⑪	Cushion B	2	61703-HB3-300
⑫	6×16mmSH Flange bolt	2	96001-06016-02
⑬	5×10mm Washer-screw	3	93892-05010-07
⑭	6×14mm Flange bolt	2	95701-06014-00
⑮	CB Controller	1	08E95-MZ0-100-01
⑯	CB Main unit	1	08E95-MZ0-101-02
⑰	Owner's Manual	1	08E95-MZ0-100-81
⑱	CB Radio FCC Rules Book	1	08E95-MAM-100-81
⑲	CB Antenna	1	08E96-MAM-100-01
⑳	Talk switch	1	08E96-MZ0-C00-01
㉑	Holder	1	37242-MN5-000
㉒	Band	1	90650-MA6-720
㉓	Noise suppressor A	1	08118-MN500-05
㉔	Noise suppressor C	1	08118-MN500-07
㉕	5mm Nut	1	94001-05000-0S
㉖	5×18mm Bolt	1	92101-05018-0A

Separately Sold

CB RADIO KIT P/N 08E95-MZ0-100

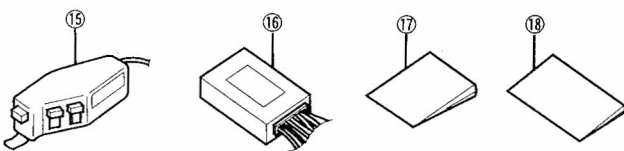

Separately Sold

CB ANTENNA P/N 08E96-MZ0-A00

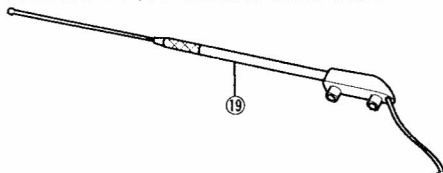

Separately Sold

PASSENGER TALK SWITCH
 P/N 08E96-MZ0-C00

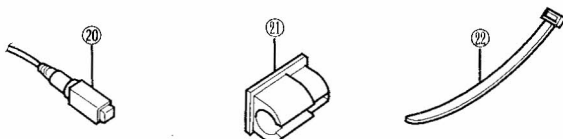

2 TOOLS AND SUPPLIES REQUIRED

- 8mm T-handle wrench
- 10mm T-handle wrench
- 12mm T-handle wrench
- 8mm Combination wrench
- 14mm Combination wrench
- Phillips® screwdriver
- Long nose pliers
- Vinyl tape
- Torque wrench
- Contact cleaner

3 PRECAUTIONS

- The engine and exhaust system will be heated during operation and remain hot shortly after stopping the engine. Allow the engine and exhaust system to cool before installing the CB Radio with this attachment kit.
- Remove the fuel tank in a well ventilated area away from sparks or flames. Wipe up spilled gasoline at once.
- Do not spray the contact cleaner directly on the body. Use a clean cloth to apply it to the body.
- Be sure to tighten all bolts and screws to the specified torques.

TORQUE CHART

Item	N·m	kgf-m	ft-lbs
6mm SH Flange bolt	9	0.9	6.5
6mm Flange bolt	12	1.2	9
8mm Flange bolt	26	2.7	20
10mm Nut	34	3.5	25

4 INSTALLATION

1. Lift the right front side cover in the direction shown.
2. Turn over the dust cover and unplug the 2-pin connectors. Plug the 2-pin connectors of the noise suppressor A in between.
3. Push the noise suppressor A into the dust cover, then reinstall the dust cover.
4. Reinstall the right front side cover.

Fig. 2

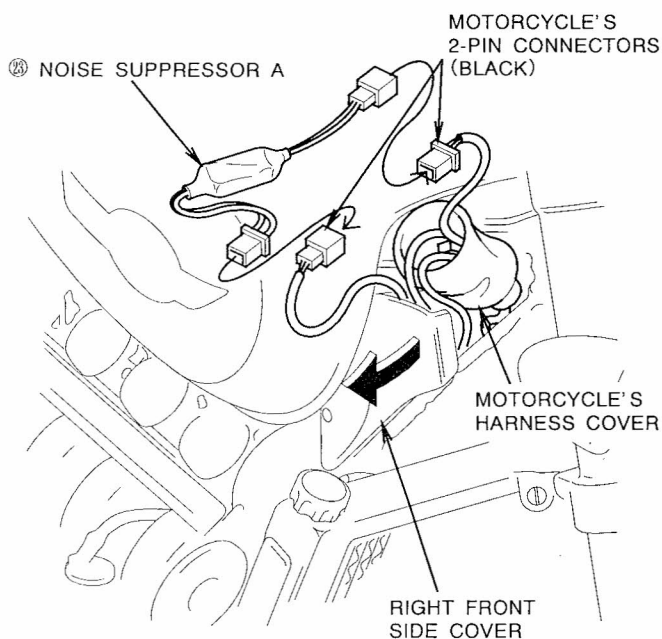

5. Remove the seat.

Fig. 3

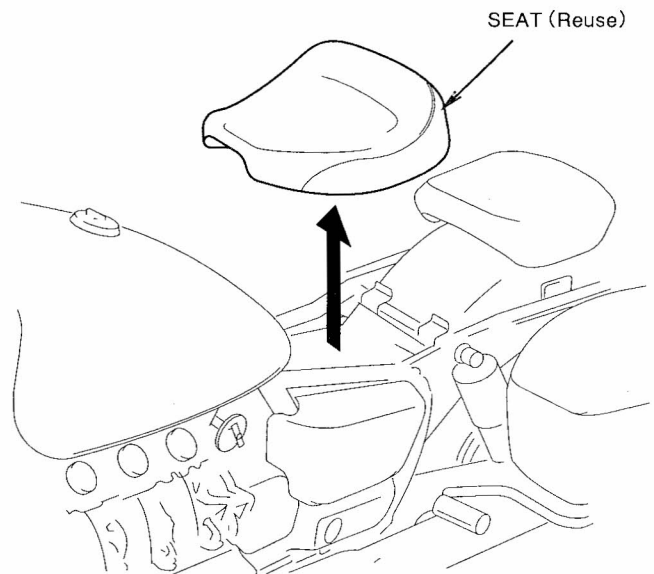

6. Remove the left side cover.
7. Remove the bolt securing the left of the center side cover.

Fig. 4

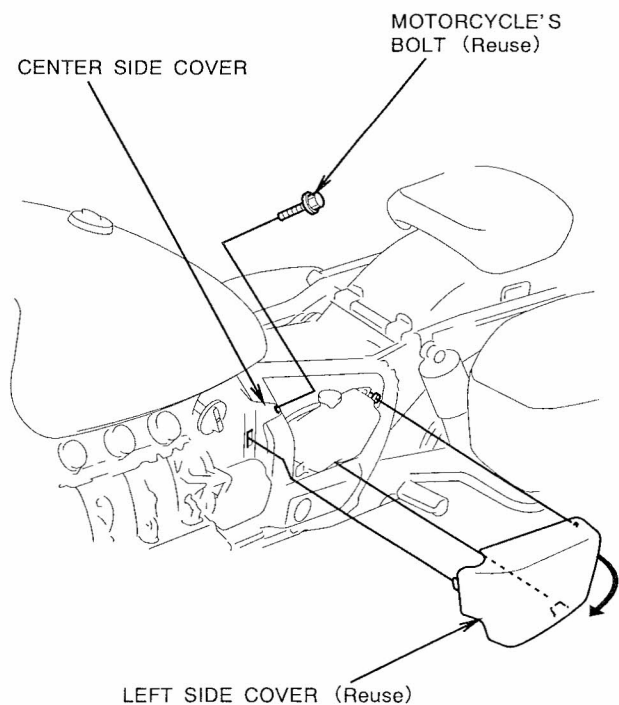

8. Remove the fuel valve lever.

Fig. 5

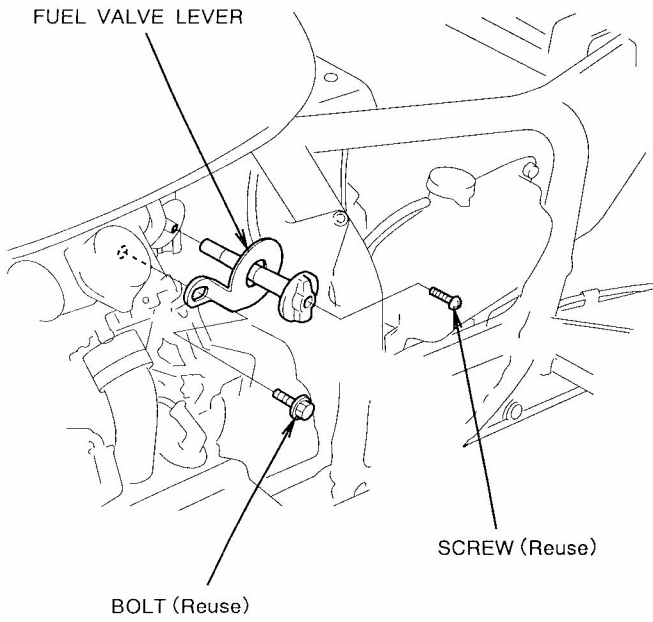

9. Remove the fuel tank.

Fig. 6

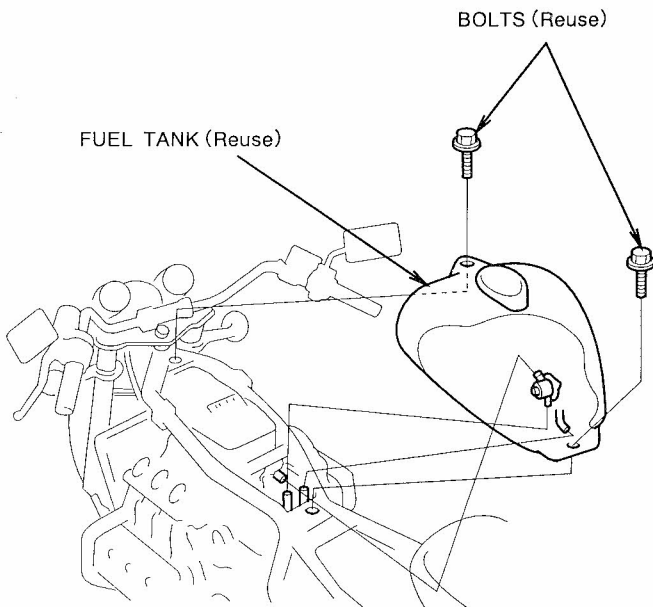

10. Remove the battery cover.

Fig. 7

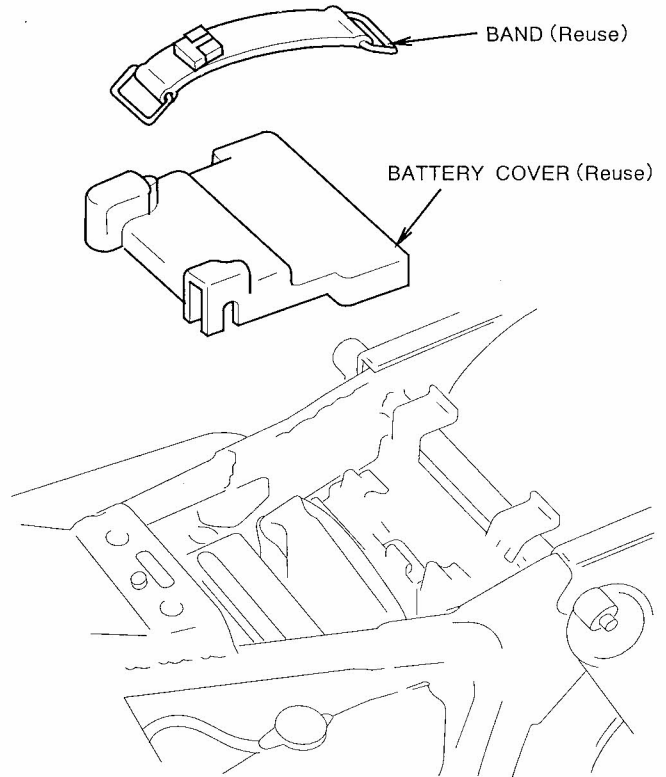

11. With the battery cover placed inside out, cut out the two recessed areas as shown.

Fig. 8

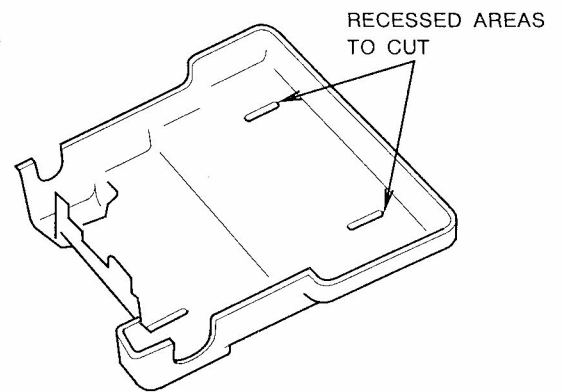

Cutting Method

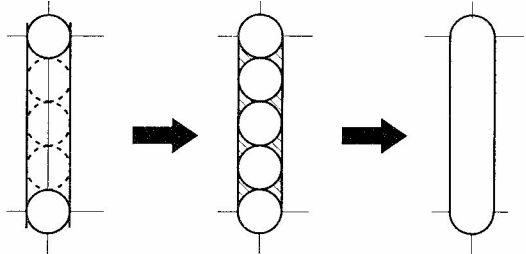

Drill several
4mm holes

Finish smooth and flat
with a file

12. From the outside, measure and mark the battery cover and lightly centerpunch the marks. Using an electric drill motor and 4mm drill bit, cut out the marked areas and finish with a file as shown.

Fig. 9

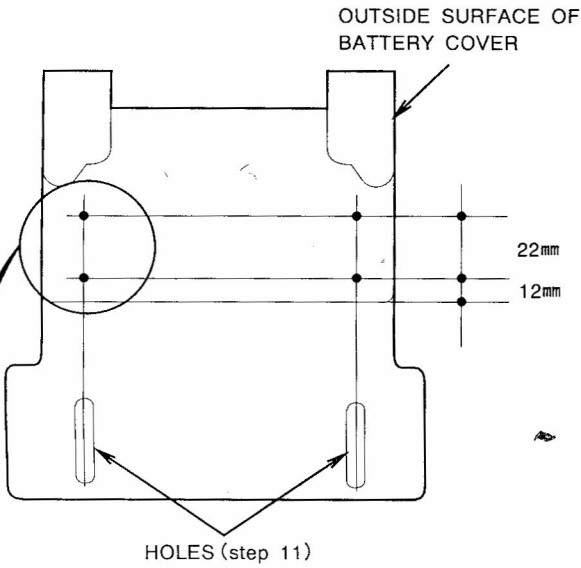

Cutting Method

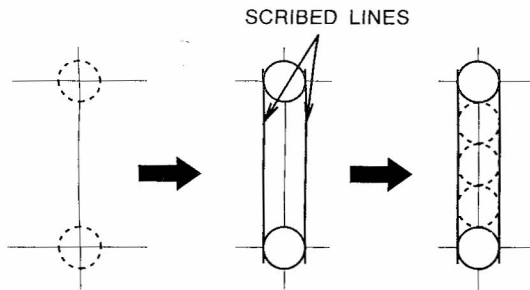

① Using a scriber, scribe a line through the centers of the two center-punched marks, then drill a 4mm hole through the center of each mark.

② Scribe a line along the edges of the two 4mm holes on both sides.

③ Using the line scribed in step ① as a guide, further drill 4mm holes through the cover as shown.

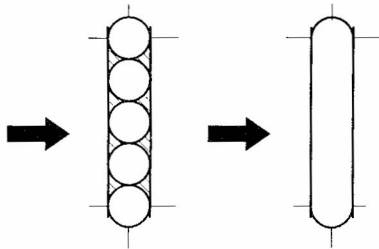

④ Finish smooth and flat with a file. Repeat steps ① through ④ on other side.

13. Disconnect the battery negative \ominus cable from the battery.

Fig. 10

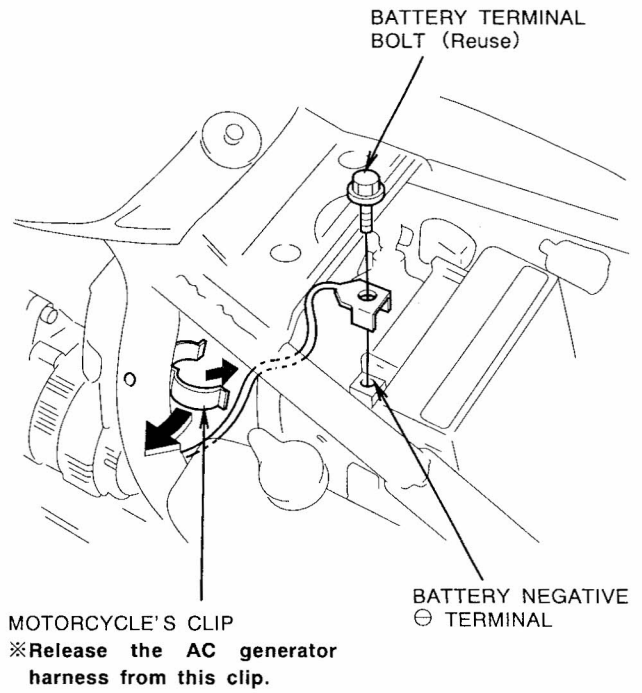

14. Remove the cover from the AC generator.

Fig. 11

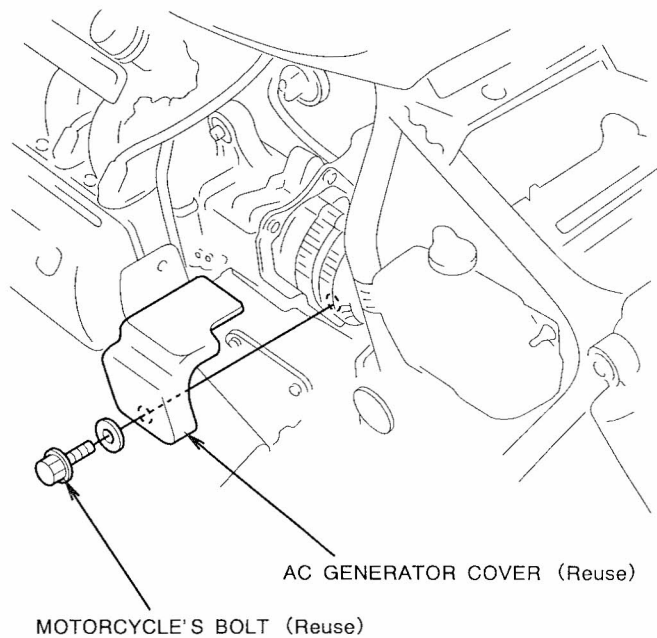

15. Remove the AC generator.

Fig. 12

AC GENERATOR
 ※Pull the AC generator out in the direction ①, then remove it in the direction ③ while rotating it in the direction ②.

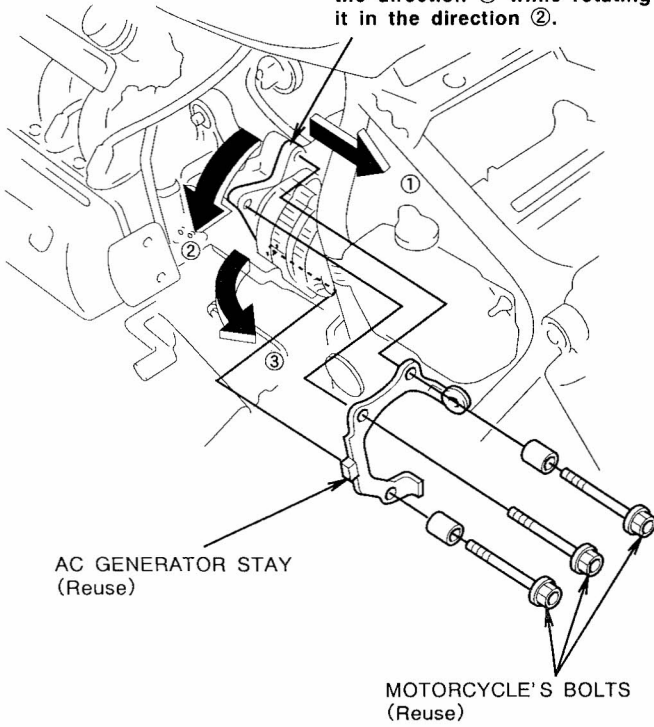

16. Install the noise suppressor C on the AC generator.

Fig. 13

MOTORCYCLE'S NUT
 ※Remove once, then use it to install the NOISE SUPPRESSOR C.

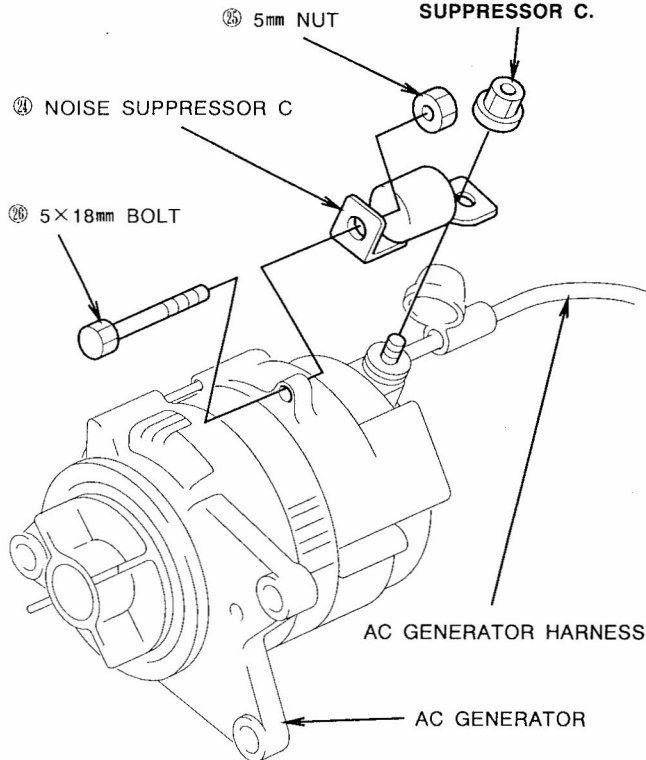

17. Install the AC generator, AC generator stay and AC generator cover in the reverse order of removal.

18. Connect the wire harness ⑤ and battery negative ⊖ cable.

Fig. 14

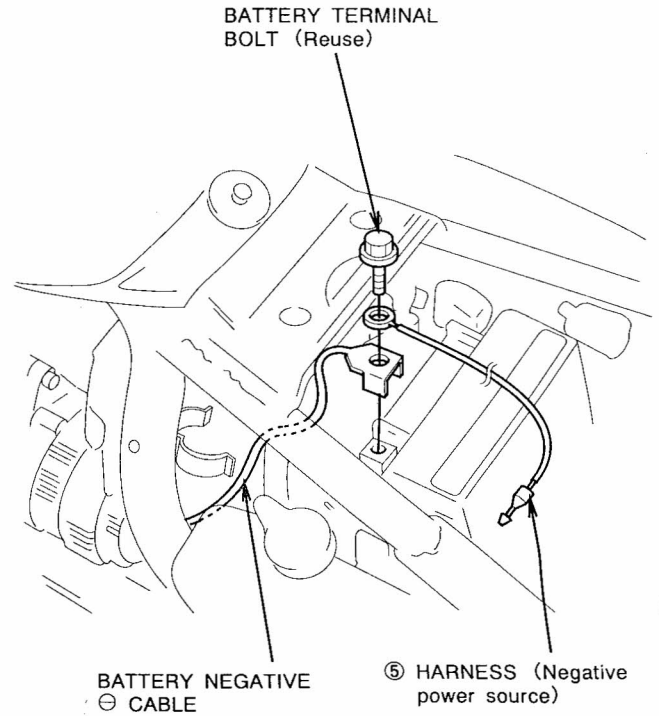

19. Slide the two fastener tapes through the holes made in steps 11 and 12 as shown.
20. Reinstall the battery cover with the band provided with the fuse positioned as shown.

Fig. 15

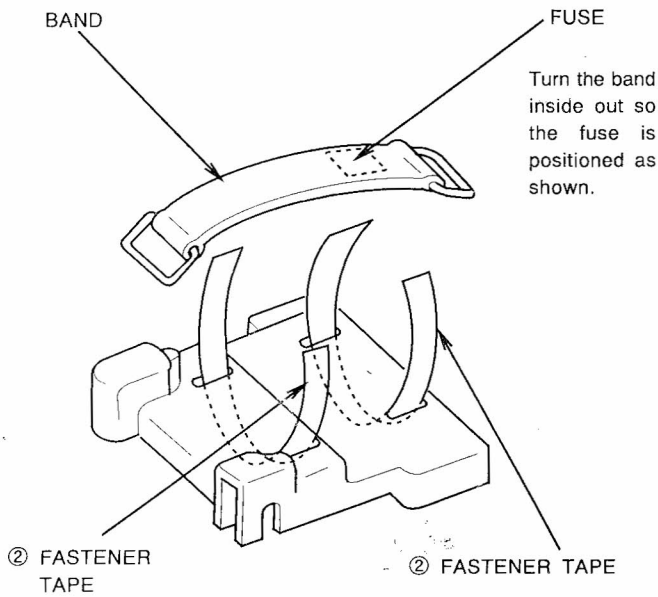

21. Route the harness as shown.

Fig. 16

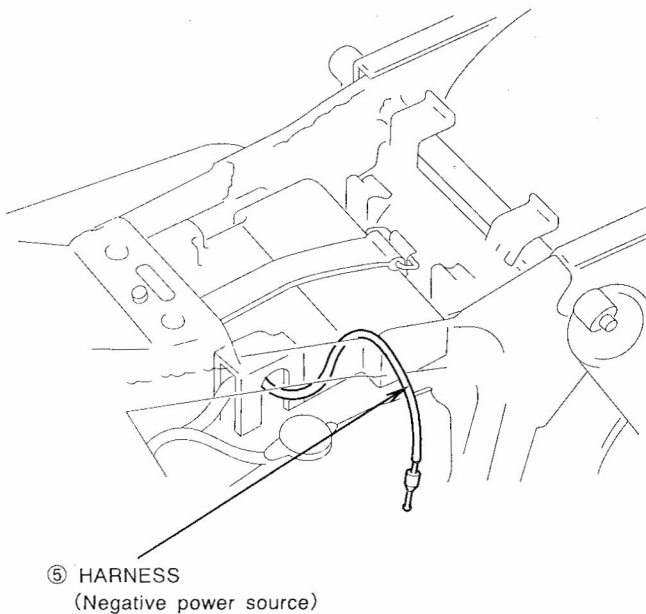

22. Remove the left rear view mirror.
23. Install the CB controller as shown.

Fig. 17

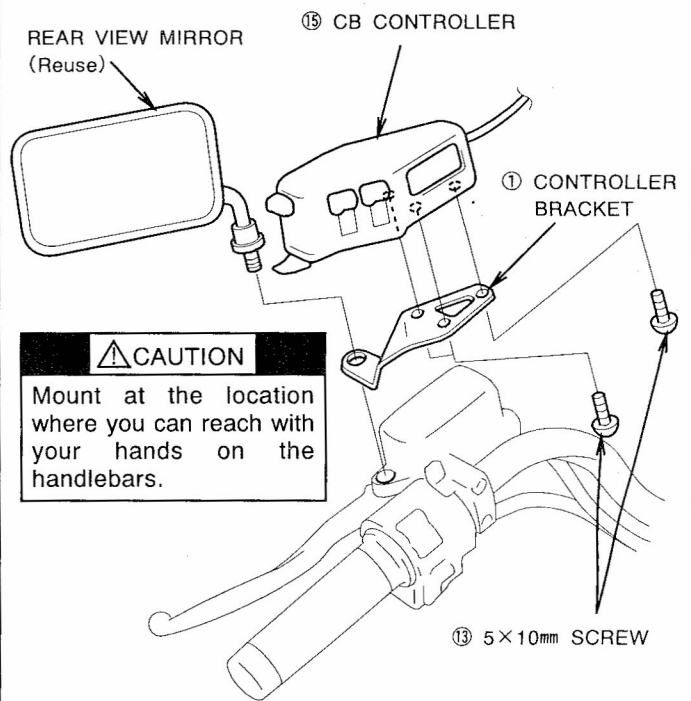

24. Secure the harness from the CB controller to the motorcycle's harness and cable with the existing wire ties, as shown.

Fig. 18

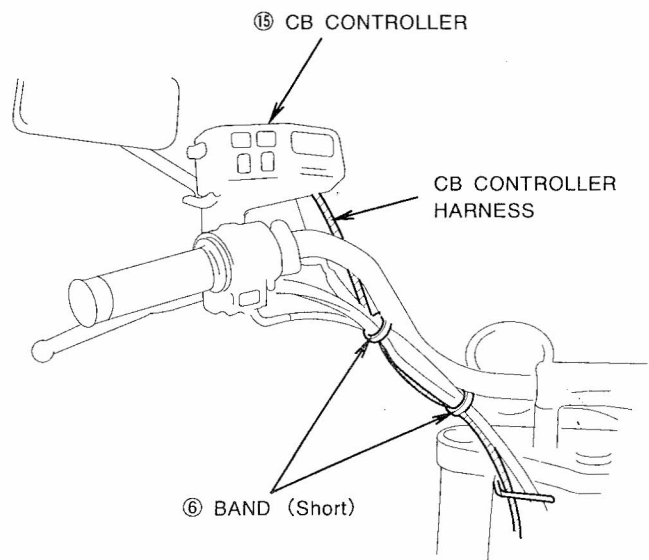

25. Route the CB controller harness as shown.

Fig. 19

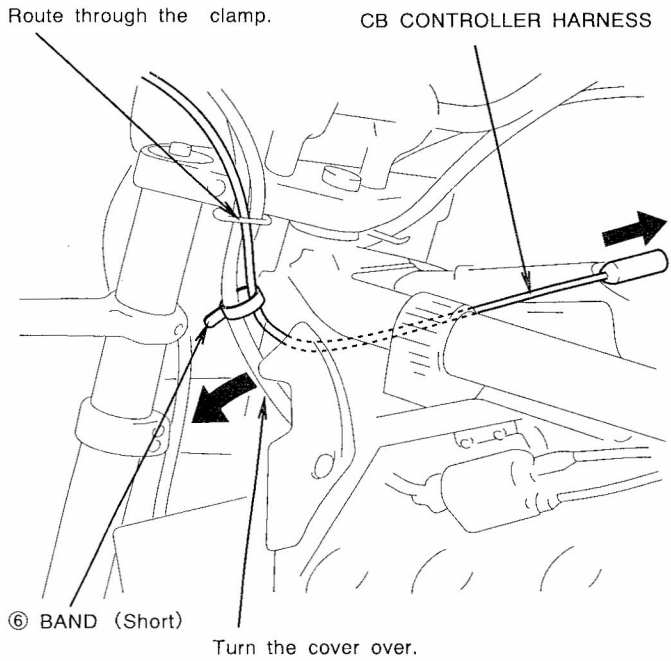

26. Install the CB antenna.

Fig. 20

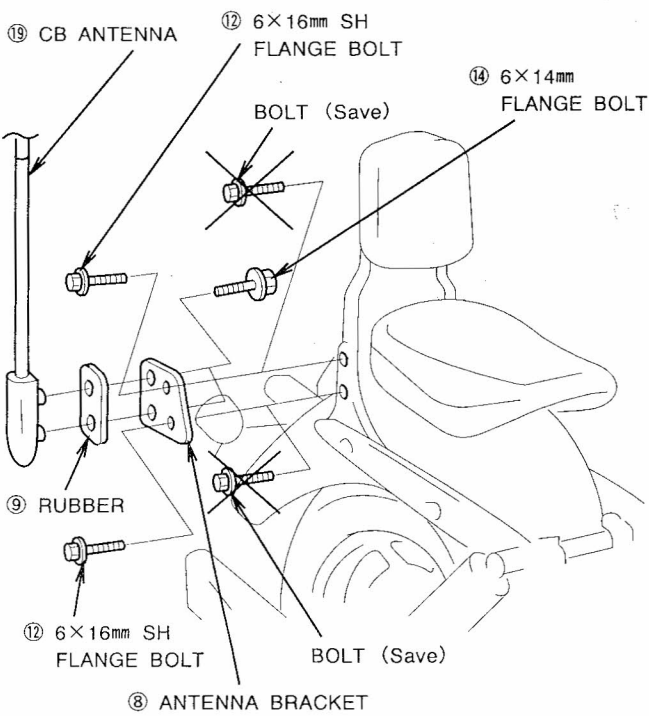

27. Attach the cushion tapes to bottom of the CB main unit in the areas shown.

Fig. 21

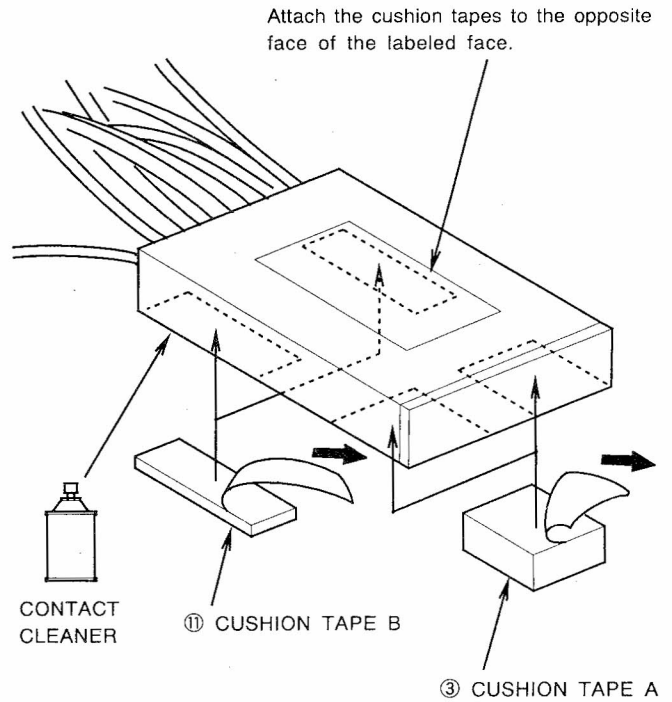

28. Install the passenger talk switch.

Fig. 22

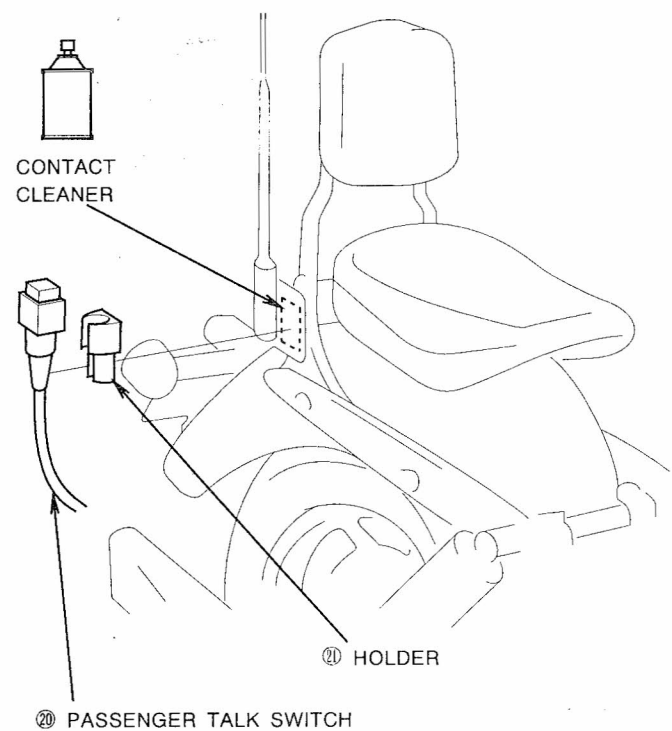

29. Remove the headlight.

Fig. 23

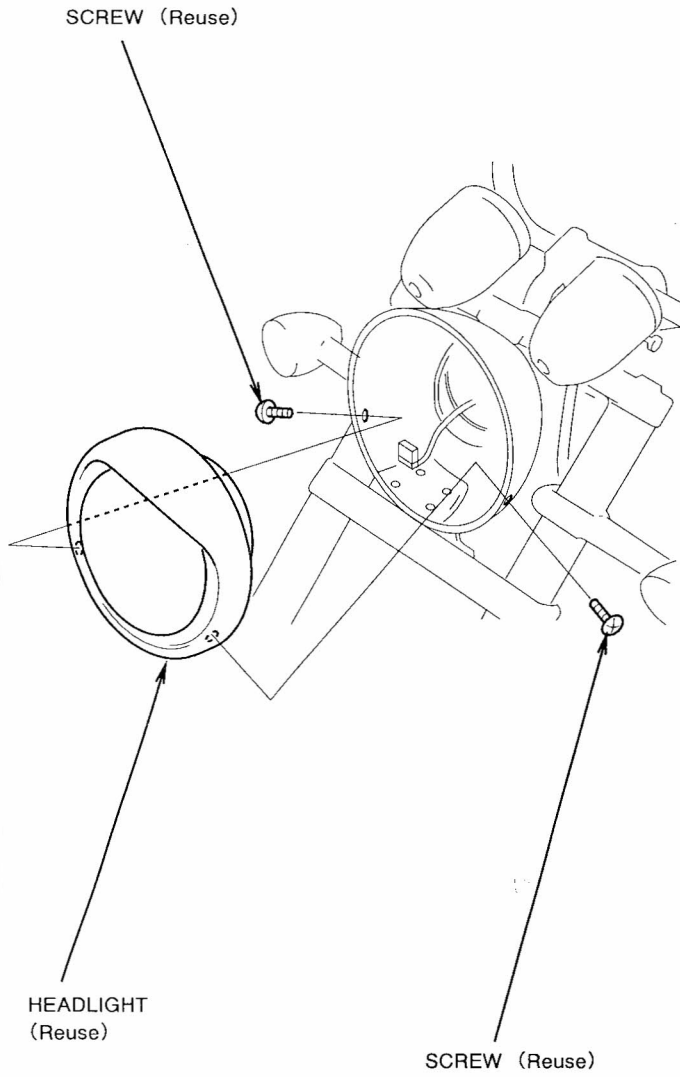

30. Unplug the motorcycle's connectors and plug the connectors of the main harness in between as shown.

Fig. 24

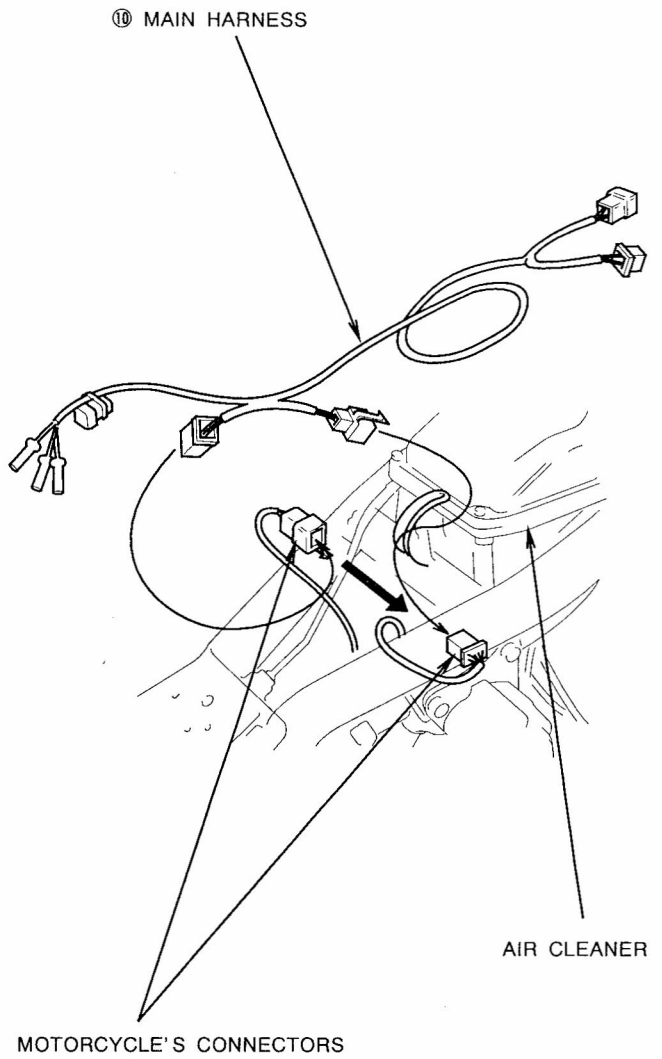

31.Route and connect the main harness connectors as shown.

Fig. 25

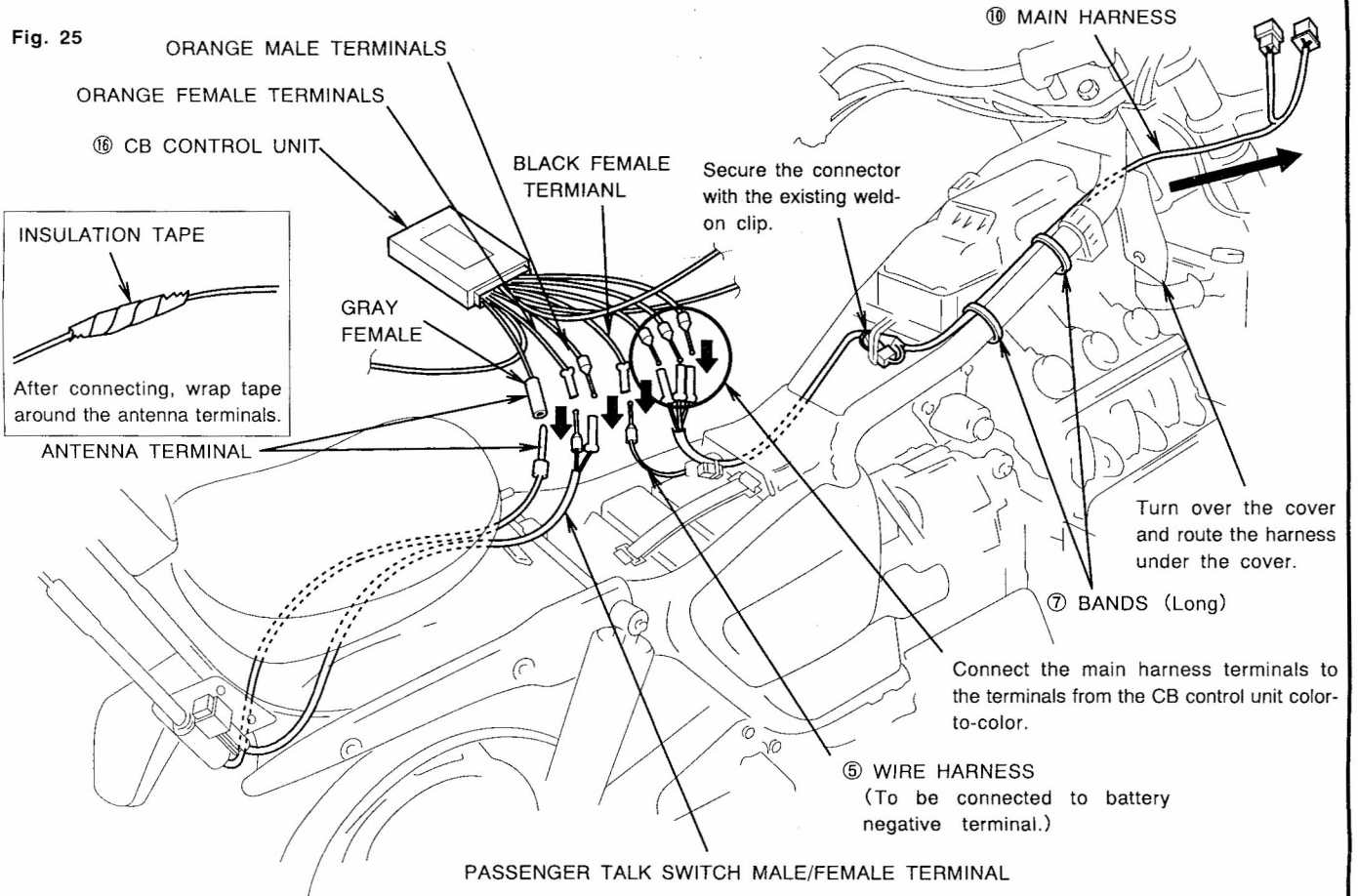
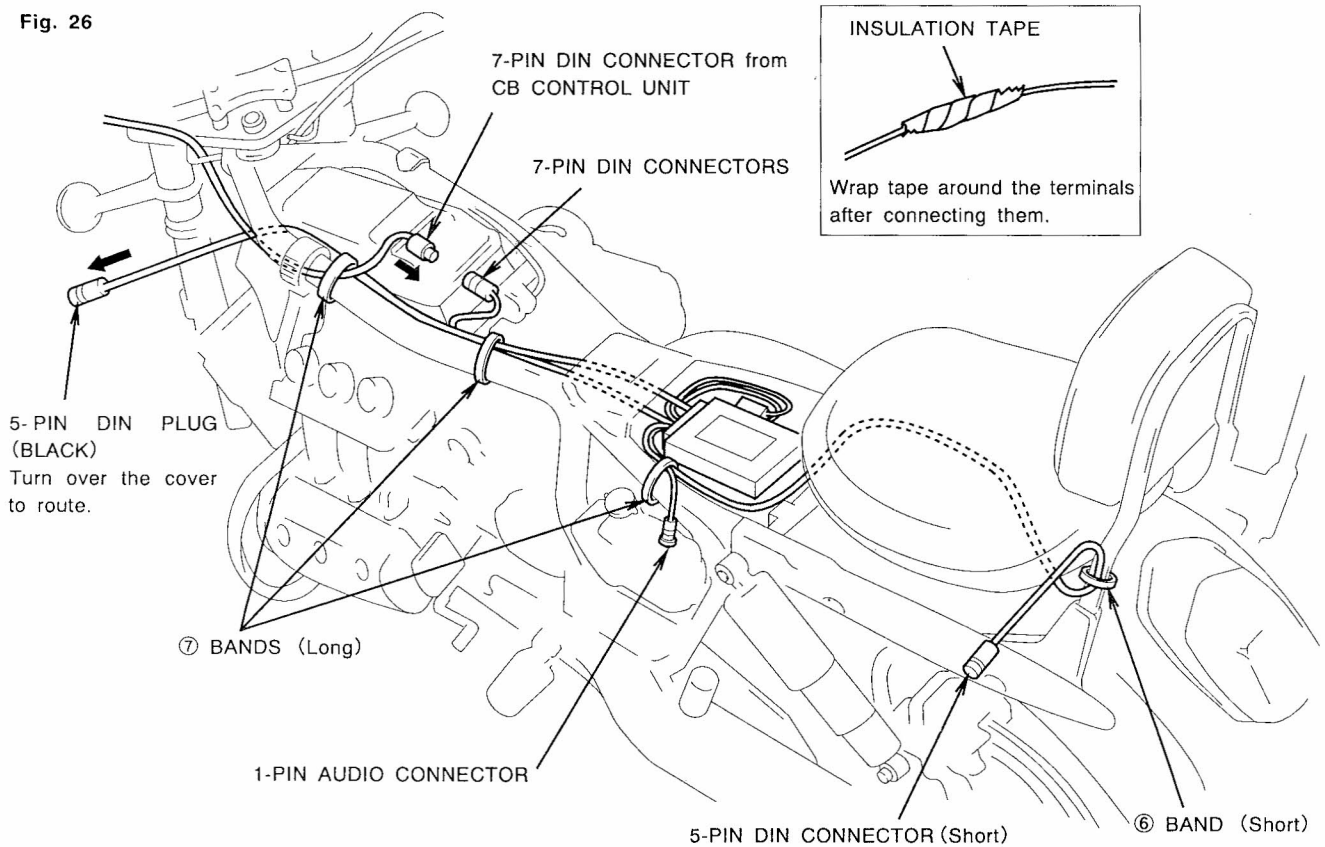

Fig. 26



32. Route the main harness forward and into the headlight case through the hole in the headlight case as shown.

Fig. 27

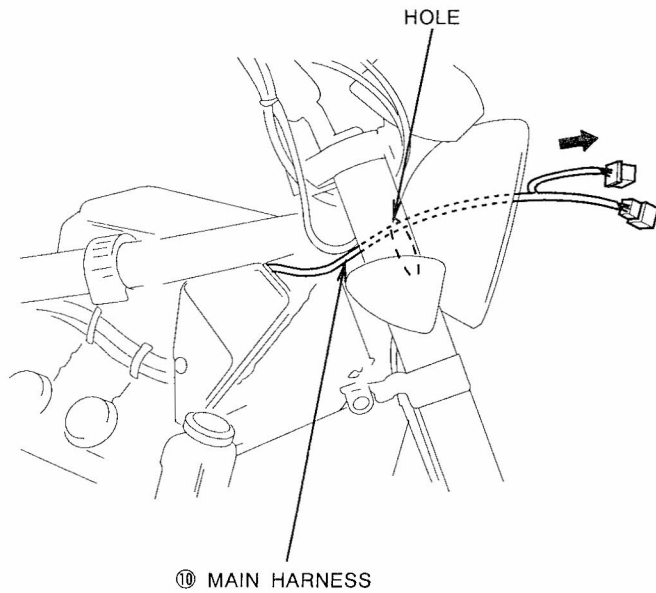
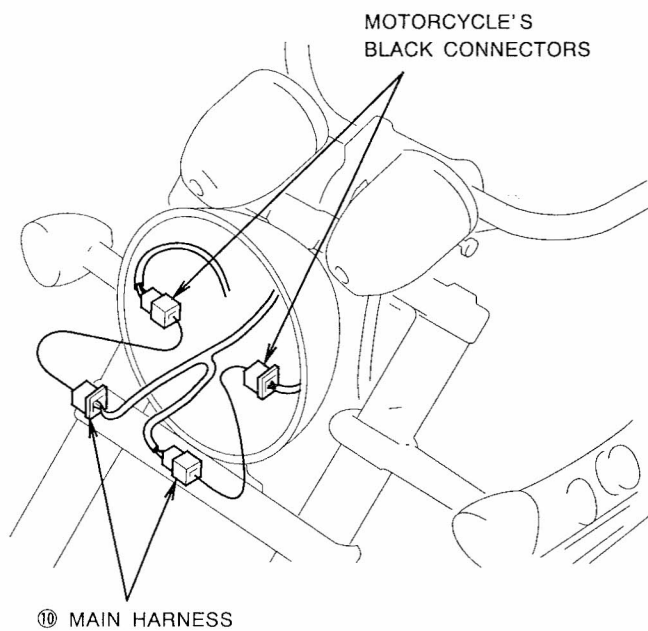
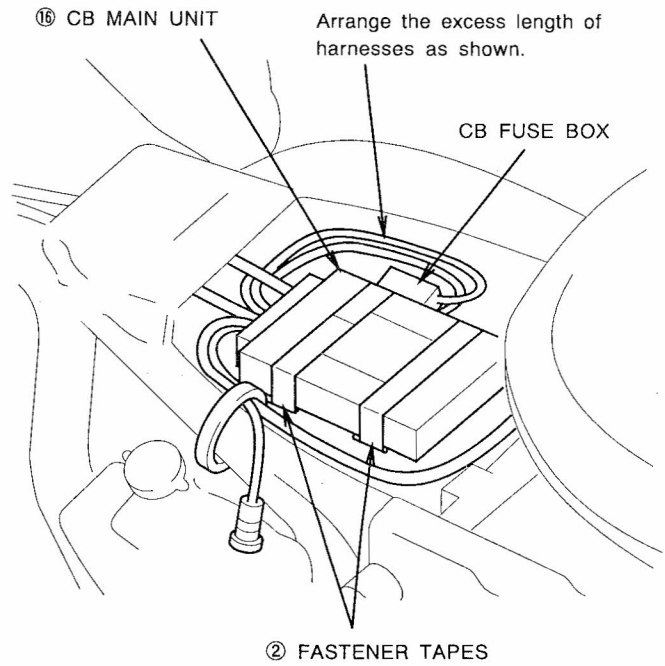

Fig. 28



33. Secure the CB main unit with the two fastener tapes.

Fig. 29



34. Reinstall the headlight, fuel tank, left side cover, center side cover and seat in the reverse order of removal.

- Take care not to pinch the wire harnesses.

35. Attach the connector holder to the fuel tank, then set the 5-pin DIN connector on the holder.

Fig. 30

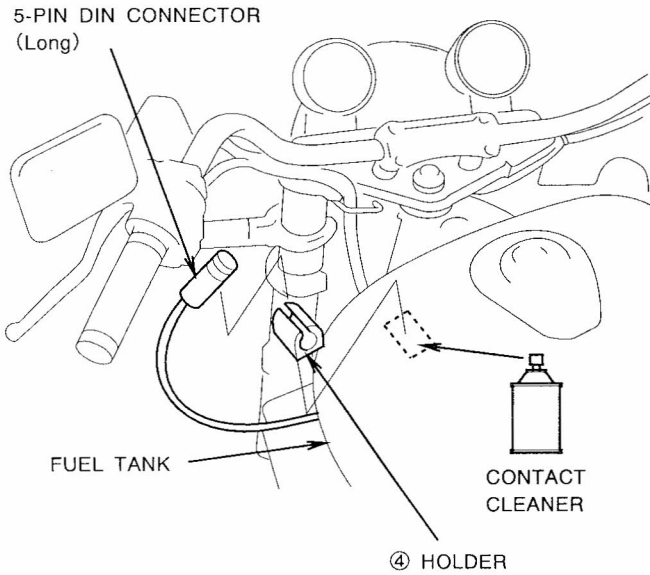

36. Attach the 5-pin DIN connector to the rear fender in the area shown.

Fig. 31

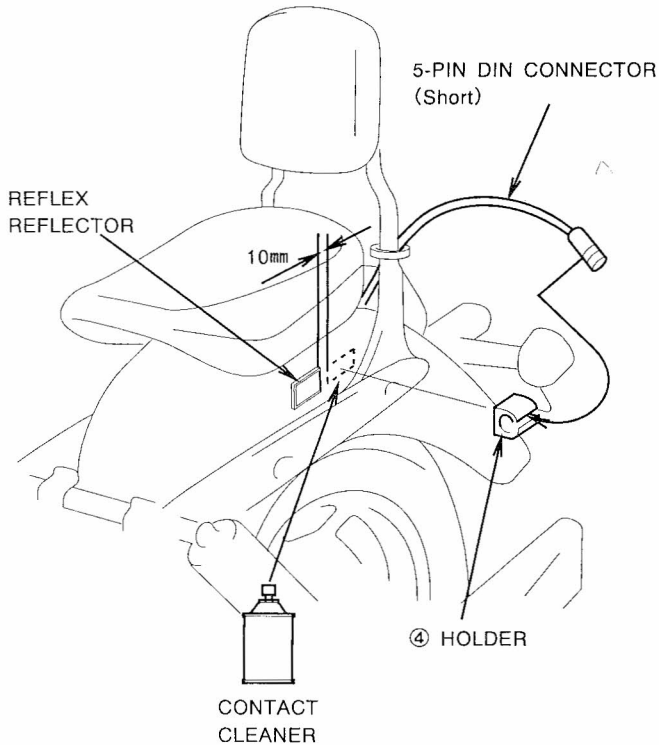

5 INSPECTION

- Check that the CB radio works properly as described in the Owner's Manual and CB Radio FCC Rules Book.
- Check operation of all lights and other electrical accessories.

READ THE OWNER'S MANUAL CAREFULLY. The Owner's Manual has additional safety and operational information.